

LEGEND

	EXISTING PROPERTY LOT LINE
	EXISTING CENTERLINE
	EXISTING RIGHT-OF-WAY LINE
	EXISTING EASEMENT LINE
	PROPOSED EASEMENT LINE
	PROPOSED WATER LINE
	PROPOSED SANITARY SEWER LINE
	PROPOSED STORM DRAIN PIPE
	EXISTING CATCH BASIN
	EXISTING CATCH BASIN - TRAPPED TYPE
	EXISTING STORM DRAIN MANHOLE
	EXISTING FIRE HYDRANT
	EXISTING WATER VALVE
	EXISTING SANITARY MANHOLE
	SANITARY SEWER CLEANOUT
	PROPOSED CATCH BASIN
	PROPOSED SANITARY CLEANOUT
	PROPOSED STORM CLEANOUT
	PROPOSED STORM MANHOLE
	PROPOSED FIRE HYDRANT
	PROPOSED FDC
	PROPOSED WATER METER

- SEWER CONSTRUCTION NOTES**
- CONNECT TO EXISTING SANITARY LINE USING 12"x8" INSERTA-TEE. 8" IE AT CONNECTION: 139.00 EX: 12" IE AT CONNECTION: 138.83 CONTRACTOR TO VERIFY INVERT ELEVATION AND LOCATION OF EXISTING SANITARY LINE PRIOR TO CONSTRUCTION.
 - INSTALL SANITARY SEWER FORCE MAIN DESIGNED BY PUMP DESIGNER.
 - INSTALL 4" PVC D-3034 SANITARY SEWER PIPE.
 - INSTALL 6" PVC D-3034 SANITARY SEWER PIPE.
 - INSTALL 8" PVC D-3034 SANITARY SEWER PIPE.
 - PROPOSED DESIGN/BUILD DUPLEX SANITARY PUMP STATION.
 - PROPOSED SANITARY MANHOLE WITH FORCE MAIN CONNECTION. SEE MANHOLE DATA TABLE ON THIS SHEET FOR INFORMATION. SEE DETAIL ON SHEET C6.2
 - 4" SANITARY SEWER CONNECTION AT BUILDING. STUB LINE 5 FEET FROM BUILDING.
 - 6" SANITARY SEWER STUB FOR FUTURE DEVELOPMENT
 - INSTALL CONDUIT FOR SANITARY PUMP ALARM TO GOODWILL BUILDING.
 - INSTALL GREASE INTERCEPTOR.
 - SANITARY/WATER CROSSING 6" SANITARY IE: 134.56
 - SANITARY/WATER CROSSING SANITARY IE: COORDINATE CROSSING WITH PUMP STATION DESIGNER.
 - SANITARY/WATER CROSSING 4" SANITARY IE: 139.93
 - SANITARY/WATER CROSSING 8" SANITARY IE: 139.08
 - SANITARY/GAS & TELECOM CROSSING 8" SANITARY IE: 139.21

- DRY UTILITY CONSTRUCTION NOTES**
- POTENTIAL GAS ROUTING FOR REFERENCE ONLY. COORDINATE ROUTING AND SERVICE WITH NW NATURAL.
- * CONTRACTOR TO COORDINATE POWER, TELEPHONE, AND CABLE SERVICE & ROUTING WITH UTILITY PROVIDERS. PROVIDE ANY NECESSARY UNDERGROUND STUBS TO FUTURE PAD LOCATIONS.

PRIVATE SANITARY PUMP STATION MANHOLE DATA	PRIVATE SANITARY MANHOLE DATA
SSMH-1 RIM: 141.32 IE IN (6"NW) = 134.17 IE IN (6"NE) = 137.21 IE OUT: TO BE DETERMINED BY PUMP STATION DESIGNER	SSMH-2 RIM: 144.17 IE IN (4"NE) = 140.11 IE IN (4"NW) = 139.64 IE IN (6"SE) = 139.54 IE OUT (8"SW) = 139.44
CLEANOUT DATA	CLEANOUT DATA
SSCO-1 RIM = 141.14'	SSCO-3 RIM = 141.28'
SSCO-2 RIM = 141.28'	SSCO-4 RIM = 141.46'

ALL STORM AND SANITARY SEWER CONNECTIONS NOT MADE AT A STRUCTURE TO BE WYE CONNECTIONS.

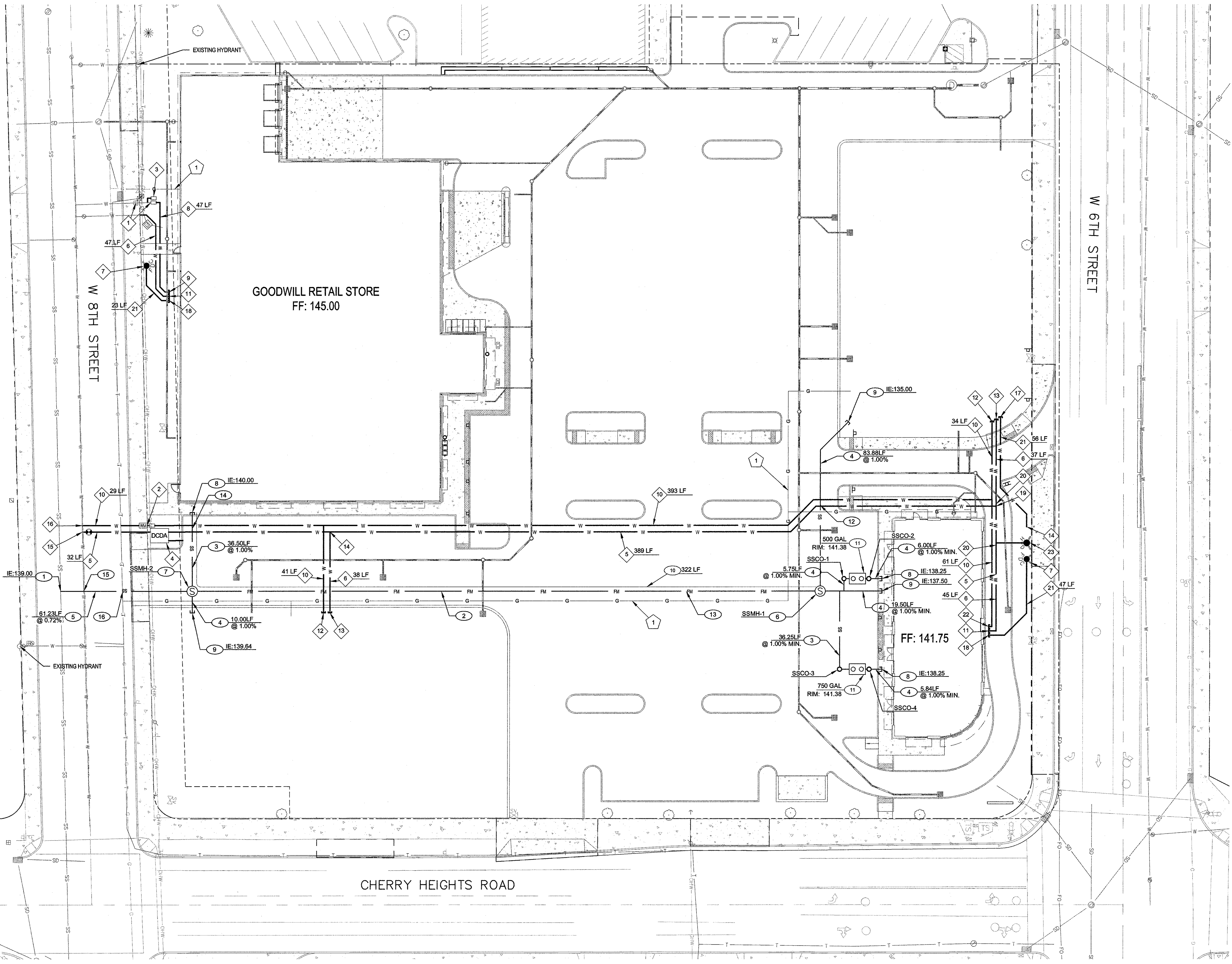

- WATER CONSTRUCTION NOTES**
- CONNECT TO EXISTING 1-1/2" METER. INSTALL DCVA PER CITY OF THE DALLES AMENDMENT #5 TO 2008 OREGON STANDARD SPECS AND OREGON HEALTH DEPARTMENT STANDARDS
 - INSTALL BOX WITH METER STOP FOR 2" DOMESTIC WATER METER AND DCVA PER CITY OF THE DALLES AMENDMENT #5 TO 2008 OREGON STANDARD SPECS, OREGON HEALTH DEPARTMENT STANDARDS AND DETAIL RD278 ON SHEET C6.3. METER TO BE INSTALLED UNDER SEPERATE BUILDING PERMIT.
 - INSTALL 1 1/2" IRRIGATION CONNECTION AND DCVA. SEE IRRIGATION PLANS FOR CONTINUATION.
 - INSTALL 8" DCVA IN 678-WA UTILITY VAULT PER OREGON PLUMBING CODE AND OREGON HEALTH DEPARTMENT STANDARDS. DAYLIGHT SUMP PUMP LINE TO WEEP-HOLE IN PROPOSED CURB.
 - INSTALL 8" C900 FIRE SERVICE LINE. MECHANICALLY RESTRAIN ALL FITTINGS AND JOINTS.
 - INSTALL 6" C900 FIRE SERVICE LINE. MECHANICALLY RESTRAIN ALL FITTINGS AND JOINTS.
 - INSTALL FIRE DEPARTMENT CONNECTION ASSEMBLY.
 - INSTALL 1-1/2" PVC DOMESTIC WATER LINE.
 - 1-1/2" DOMESTIC WATER CONNECTION AT BUILDING. STUB 5' FROM BUILDING.
 - INSTALL 2-1/2" DOMESTIC WATER LINE FOR PAD BUILDINGS.
 - 6" FIRE SERVICE CONNECTION AT BUILDING. STUB 5' FROM BUILDING. DCDA LOCATED IN BUILDING.
 - 2-1/2" DOMESTIC STUB FOR FUTURE PAD BUILDINGS. CAP AND MARK END WITH BLUE PAINTED 2x4.
 - 6" C900 FIRE SERVICE STUB FOR FUTURE PAD BUILDINGS. CAP AND MARK END WITH BLUE PAINTED 2x4.
 - FUTURE FIRE DEPARTMENT CONNECTION ASSEMBLY LOCATION TO BE INSTALLED WITH FUTURE DEVELOPMENT. CAP AND MARK WITH BLUE PAINTED 2x4.
 - INSTALL 8"x8" HOT TAP WITH 8" GATE VALVE.
 - INSTALL 2-1/2" SERVICE OFF EXISTING 8" LINE.
 - FDC STUB FOR FUTURE PAD BUILDING. CAP AND MARK END WITH BLUE PAINTED 2x4.
 - FDC STUB FOR CONNECTION AT BUILDING. STUB 5' FROM BUILDING.
 - INSTALL 8"x8" MJX MJ TEE WITH MECHANICAL RESTRAINT PER TABLE ON THIS SHEET.
 - INSTALL 8"x8" REDUCER WITH MECHANICAL JOINT RESTRAINT PER TABLE ON THIS SHEET.
 - INSTALL 4" C900 FDC LINE. MECHANICALLY RESTRAIN ALL FITTINGS AND JOINTS.
 - 2-1/2" DOMESTIC WATER CONNECTION AT BUILDING. STUB 5' FROM BUILDING.
 - INSTALL PRIVATE FIRE HYDRANT PER DETAILS ON SHEET C6.4.

MJ RESTRAINT LENGTH TABLE

MAINLINE	BENDS				REDUCERS
	90°	45°	22.5°	11.25°	
6"	26"	11"	6"	3"	6" 43"
8"	33"	14"	7"	4"	

BRANCH	TEES		DEAD END
	6"	8"	
MAINLINE	8"	70"	6" 78"

- ASSUMPTIONS:**
- PIPE MATERIAL: C900
 - SOIL TYPE: NATIVE SOIL BACKFILLED WITH GRANULAR MATERIAL
 - SAFETY FACTOR: 1.5:1
 - TRENCH TYPE: 5
 - DEPTH OF BURY: 3'
 - TEST PRESSURE: 200 PSI
 - TEE RESTRAINT LENGTH ALONG MAINLINE RUN: 1'

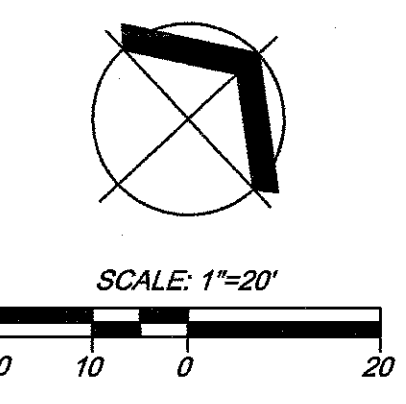

CARDNO PROJECT # 21201580

Cardno
 Shaping the Future

PORTLAND
 5415 SW WESTGATE DR. STE 100, PORTLAND, OR 97221
 TEL: (503) 419-2500 FAX: (503) 419-2600
 www.cardno.com