

PURPOSE	
PRELIMINARY	
BID	
APPROVAL	
CONS	
AS BUILT	

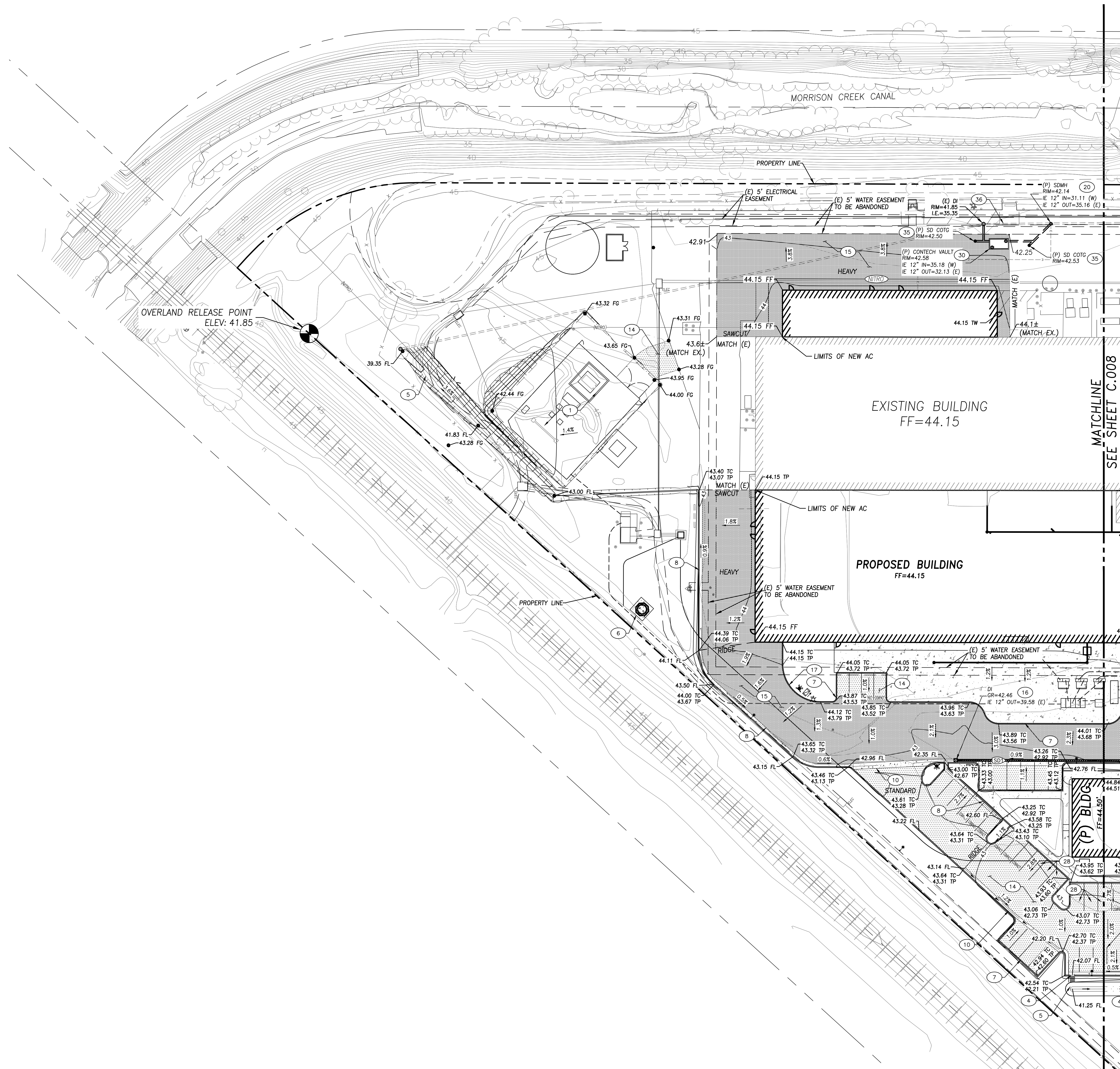

MATCHLINE SEE SHEET C.008

NOTE:

CITY REQUIRES ENGINEER INSPECTION AND CERTIFICATION UPON COMPLETION OF THE STORMWATER FACILITY TO ENSURE THE FACILITY IS BUILT PER PLANS. CERTIFICATION LETTER SHOULD BE MAILED TO THE CITY OF SACRAMENTO DEPARTMENT OF UTILITIES WATER QUALITY (1395 35TH AVE, SACRAMENTO, CA 95822) FOR CITY RECORDS.

PIPE NAME	LENGTH	INFORMATION	BEARING	RADIUS
SD1	180 LF	12" PVC @ 0.5%	S77° 53' 31"E	0.0

**CONSTRUCTION NOTES**

- 1 PROPOSED SMUD SUBSTATION. SEE PLANS BY OTHERS
- 2 PAINT 4" WHITE PARKING STRIPES (TYP)
- 3 RECONSTRUCT ACCESSIBLE PARKING STALLS PER DETAIL 4 ON SHEET C.015
- 4 PLACE CURB OPENINGS EVERY 25' AND AT LOW POINTS PER DETAIL 7 ON SHEET C.013
- 5 CONSTRUCT (9" TOP, 3" BOTTOM BASE) VEGETATED SWALE PER DETAIL 6 ON SHEET C.013.
- 6 PROPOSED EXHAUST STACK BY SEPARATE PERMIT
- 7 INSTALL CONCRETE CURB PER DETAIL 8 ON SHEET C.013
- 8 INSTALL CONCRETE CURB AND GUTTER PER DETAIL 2 ON SHEET C.016
- 9 INSTALL CONCRETE SIDEWALK PER DETAIL 5 ON SHEET C.015
- 10 INSTALL CONCRETE VEE GUTTER PER DETAIL 9 ON SHEET C.013
- 11 INSTALL THRU CURB AND GUTTER PER DETAIL 10 ON SHEET C.013
- 12 INSTALL UNDERSIDEWALK DRAIN PER DETAIL 11 ON SHEET C.013
- 13 INSTALL ACCESSIBLE RAMP PER DETAIL 6 ON SHEET C.015
- 14 INSTALL STANDARD DUTY AC PAVEMENT PER DETAIL 9 ON SHEET C.016
- 15 INSTALL HEAVY DUTY AC PAVEMENT PER DETAIL 9 ON SHEET C.016
- 16 INSTALL 36" X 42" DRAIN INLET PER DETAIL 1 ON SHEET C.016
- 17 INSTALL VARYING CURB FROM 0" TO 6" IN HEIGHT PER DETAIL 12 ON SHEET C.015
- 18 CONNECT TO EXISTING DRAIN INLET. ADJUST TO GRADE
- 19 CONCRETE PAD AND BIKE RACK. SEE DETAIL 5 ON C.015 AND LANDSCAPE PLANS.
- 20 INSTALL CONTECH STORMFILTER MODEL SFPD0612 OR APPROVED EQUAL PER DETAIL 10 ON SHEET C.014. CONNECT PROPOSED MANHOLE TO STORMFILTER WITH 12" STORM DRAIN PIPE.
- 21 PROPOSED GUARD SHACK - SEE ARCHITECTURAL PLANS.
- 22 PROPOSED CHAIN LINK FENCE PER ARCHITECTURAL PLANS.
- 23 CONSTRUCT CONCRETE STAIRS WITH 6" RISERS. SEE ARCHITECTURAL PLANS.
- 24 (E) GUY WIRE. PROTECT IN PLACE
- 25 (P) "EXIT ONLY" SIGN
- 26 (P) "DELIVERIES AND OFFICE" SIGN
- 27 (P) KNOX BOX SEE ARCHITECTURAL PLANS
- 28 PAINT "CARPOOL/VANPOOL ONLY" FOR DESIGNATED CARPOOL SPACES
- 29 SEE LS 100 FOR 3 HR FIRE RATED WALL
- 30 INSTALL CONTECH STORMFILTER MODEL SFPD0612 OR APPROVED EQUAL PER DETAIL 10 ON SHEET C.014. CONNECT PROPOSED MANHOLE TO STORMFILTER WITH 12" STORM DRAIN PIPE.

**LEGEND**

- BUILDING LINE
- EXISTING BUILDING LINE
- PROPOSED STANDARD DUTY PAVEMENT AREA
- PROPOSED HEAVY DUTY PAVEMENT AREA
- PROPOSED SITE CONCRETE
- ADA DETECTABLE WARNINGS
- PASSENGER DROP-OFF ZONE
- CROSSWALK STRIPING
- SAWCUT LINE
- PROPOSED 6" CHAIN LINK FENCE
- PROPOSED LIGHT
- (P) CURB
- PROPERTY LINE
- MAJOR CONTOUR
- MINOR CONTOUR
- EXISTING MAJOR CONTOUR
- EXISTING MINOR CONTOUR
- ADA PATH-OF-TRAVEL
- FLOWLINE
- AREAS TO BE GRADED

**SOIL QUANTITIES**

CUT	3000 CU YD
FILL	4500 CU YD
NET	1500 CU YD FILL

NOTE: SEE HORIZONTAL CONTROL PLAN FOR PAVEMENT SECTIONS

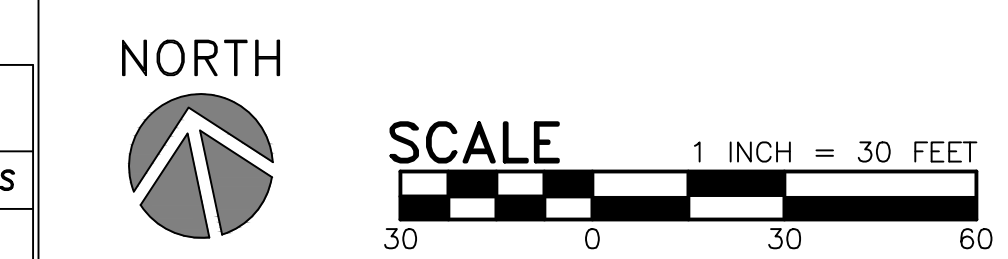

**CONSTRUCTION NOTES CONT'D**

- 31 INSTALL FLARED END SECTION ON END OF PIPE
- 32 INSTALL 10" ORIFICE PLUG ON NEW SD OUT
- 33 INSTALL CONCRETE PAD FOR DOUBLE DETECTOR VALVE AND MATCH EXISTING RETAINING WALL AROUND PAD
- 34 INSTALL CONTECH STORMFILTER MODEL SFPD0811 OR APPROVED EQUAL PER DETAIL 9 ON SHEET C.014. CONNECT PROPOSED MANHOLE TO STORMFILTER WITH 12" STORM DRAIN PIPE.
- 35 CONSTRUCT STORM DRAIN CLEANOUT. SEE DETAIL 7 ON SHEET C.016.
- 36 ABANDON IN PLACE STORM DRAIN PIPE.

REV.	DATE	DRN.	CHKD.	APPR.	DESCRIPTION
6A	1-6-15				
7A	1-19-15				
8A	2-2-15				
8B	2-10-15				
8C	4-14-15				
8D	6-22-15				
8E	6-30-15				
9	7-15-15				

[smart design]<sup>SM</sup>  
**Luckett & Farley**  
ARCHITECTS

**kpff**

1508 Executive Rd., Suite 250  
Roseville, CA 95661  
P: 916.772.7898  
F: 916.772.7899  
www.kpff.com

**Gray**

10 Quality Street  
Livermore, Kentucky 40501-1450  
Telephone: (858) 281-6000  
Facsimile: (858) 252-6300

Manufacturing - Automotive  
Food & Beverage - Distribution  
Retail - Hospitality

REGISTERED PROFESSIONAL ENGINEER  
CHRY E. GARRETT  
No. C2684  
Exp. 6/30/15  
CIVIL ENGINEER  
STATE OF CALIFORNIA

MRCFAC  
**L33 PROJECT**  
SACRAMENTO, CALIFORNIA  
**GRADING PLAN**

DOCUMENT NUMBER	
DEPARTMENT	
JOB NUMBER	214-548
SHEET NUMBER	C.007

File: C:007-008 MRCFAC Grading Plans.dwg TAB:C.007  
Printed: 7/15/15 at 1:50pm by: jacob@acosta.com  
XREF: 214-548.dwg - Fileblock 214-548.dwg - Utility Design E3.0.0 - General Arrangement